

# ROBINIA RB1242



2+



11 kids



32,7 m²



## Material specification

- Construction made of Robinia - very durable acacia wood with a diameter of ~ 18 cm without sharp edges, resistant to weather conditions,
- Platforms made of Robinia - very durable acacia wood, resistant to weather conditions,
- Side panels made of Robinia - very durable acacia wood without sharp edges, resistant to weather conditions
- Slides made of stainless steel,
- Moving elements made of durable HPL plate, resistant to weather conditions,
- Dashboard and steering wheel made of durable HDPE plate, resistant to weather conditions,
- Steel ropes in polypropylene braid, connected with durable plastic elements, stainless steel or aluminum,
- Calibrated stainless steel chains, preventing fingers entrapment,
- Screws covered with plastic caps and/or stainless steel screws,



### Facilitating disability



easy access



shelters



integration



### Intellectual development



manipulation



thinking



### Physical development



hiding



sliding



climbing



crawling





**1**

number of towers



**1**

number of slides



**1**

number of interactive elements



**3**

number of activity elements

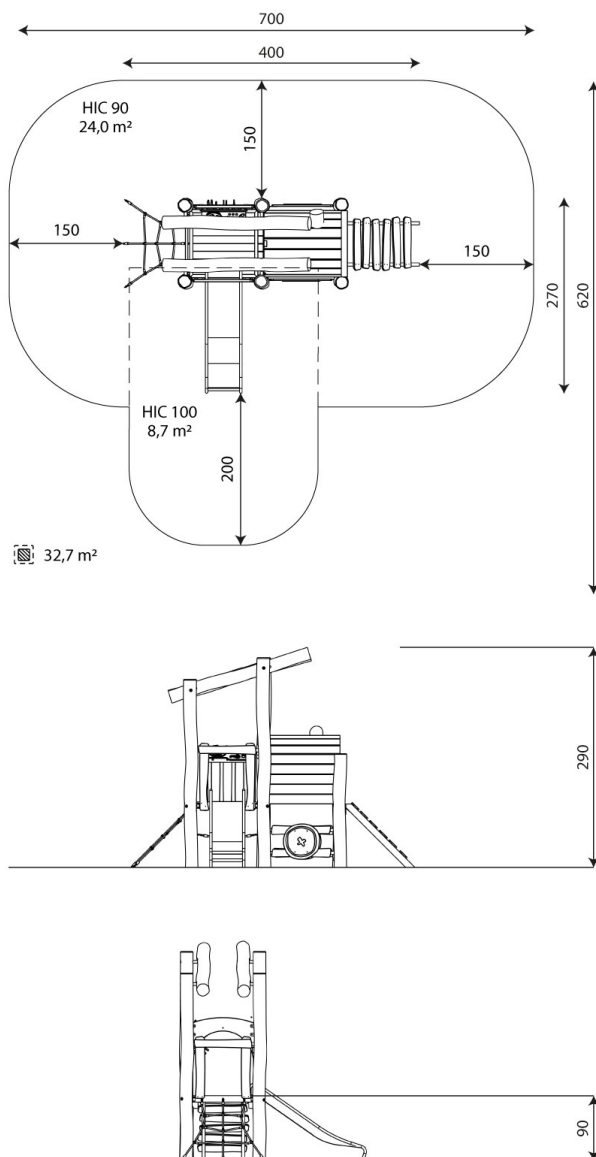

## Product technical sheet

# ROBINIA RB1242

## Product data

|                                |              |
|--------------------------------|--------------|
| Length                         | 400 cm       |
| Width                          | 270 cm       |
| Total height                   | 290 cm       |
| Age group                      | 2+ years     |
| Number of users                | 11 kids      |
| Safety zone                    | 32,7 m2      |
| Free fall height               | 90 cm        |
| The height of the platforms    | 90 cm        |
| In accordance with norm EN     | 1176-1:2017  |
| Weight of the heaviest part    | 81 kg        |
| Dimensions of the largest part | 350x18x18 cm |
| Availability of spare parts    | YES          |
| Installation time              | 5,0 h        |

Data is subject to change without prior notice.

## Additional information

- equipment adapted for the disabled; intended for public playgrounds;
- equipment has a certificate issued by an accredited entity or a declaration of conformity;
- no sharp edges or chinks that would pose a danger of jimmie the head, fingers or any other body parts;
- anchoring on flat surface, 80/70/60 cm deep;
- slide should not be installed southwards;
- render is for reference only, the actual appearance of the equipment and its color may vary;

## Guarantee

**30**

30 year guarantee - Structural strength of steel and stainless steel components

**15**

15 year guarantee - Structural failure of steel and stainless steel, for dynamic equipment

**10**

10 year guarantee - Structural failure of high density polyethylene and high pressure laminates components

**5**

5 year guarantee - Corrosion of stainless steel and hot dip galvanized and powder coated components; against bark beetles and rot in case of wooden structural elements

Detailed information in the guarantee card

**Vinci Group Sp. z o.o.**  
Seminarnyja 9 Street  
99-400 Łowicz

VAT: 534-250-14-46  
PHONE: +48 42 203 24 99 ext. 26  
M: +48 793 404 991



biuro@vinci-play.com  
info@vinci-play.com  
[www.vinci-play.com](http://www.vinci-play.com)

## Surfaces according to EN 1176-1:2017

|                                 | Description (mm)             | Layer thickness (cm) | Maximum fall heights (cm) |
|---------------------------------|------------------------------|----------------------|---------------------------|
| Turf/ top layer of soil (A,B,C) | -                            | -                    | ≤100                      |
| bark (A,C)                      | Particle size from 20 to 80  | 30                   | ≤200                      |
|                                 |                              | 40                   | ≤300                      |
| woodchips (A,C)                 | Particle size from 5 to 30   | 30                   | ≤200                      |
|                                 |                              | 40                   | ≤300                      |
| sand or gravel (A,C)            | Particle size from 0,25 to 8 | 30                   | ≤200                      |
|                                 |                              | 40                   | ≤300                      |
| synthetic attested (A,B,C)      | Tested according to EN 1177  |                      | 100                       |

## Product technical sheet

# ROBINIA RB1242

### Amount of safe surface corresponding with free fall height:

HIC 90 24,0 m<sup>2</sup>

HIC 100 8,7 m<sup>2</sup>

Data is subject to change without prior notice.

